

STAINLESS STEEL 304-A2 HEX SCREW FULL THREAD (DIN 933 / IS 1363)

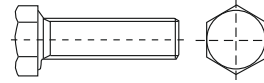

TABLE - 1A

DIA	10	12	16	20	25	30	35	40	45	50	55	60	65	70	75	80	85	90	100
3	189	208	217	241	276	435	523	646	733	752	-	-	-	-	-	-	-	-	-
4	239	246	268	298	334	399	463	634	681	710	749	791	838	886	938	993	1047	1102	1212
5	329	350	375	422	475	543	632	749	820	877	1588	1783	1990	2088	2206	2392	2546	2712	3091
6	461	473	529	593	668	746	824	899	969	1049	1223	1283	1396	1464	1619	1680	1874	1915	2131
8	-	-	1085	1191	1314	1494	1608	1743	1940	2052	2231	2328	2539	2613	2735	2969	3145	3364	3617
10	-	-	2067	2170	2397	2596	2816	3041	3289	3544	3782	4016	4322	4449	4781	4927	5301	5407	5791
12	-	-	-	3281	3546	3794	4173	4505	4805	5177	5452	5775	6082	6387	6729	7028	7402	7687	8364
14	-	-	-	-	6058	6424	6902	7284	7807	8252	8848	9147	9823	10194	10690	11203	12190	12808	13183
16	-	-	-	-	7486	7721	8317	8918	9484	10117	10726	11399	11846	12174	12871	13647	14233	14811	16195
18	-	-	-	-	-	-	-	13495	14526	15092	16342	16978	18032	18676	19733	20507	21344	22018	23241
20	-	-	-	-	-	-	-	15436	16594	17435	18114	19081	20201	21362	22178	23232	24137	25115	26935
22	-	-	-	-	-	-	-	25782	27471	28277	29916	31553	33192	34829	36468	38107	39745	41384	44660
24	-	-	-	-	-	-	-	-	-	29361	30987	32591	34138	35838	37299	38883	40444	40747	43867

STAINLESS STEEL 304-A2 HEX SCREW FULL THREAD (BS - 1083)

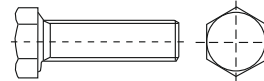

TABLE - 1B

BSW	1/2"	3/4"	1"	1.1/4"	1.1/2"	2"	2.1/2"	3"	3.1/2"	4"	5"	6"	7"	8"
1/8"	279	302	325	547	679	762	-	-	-	-	-	-	-	-
3/16"	314	364	414	497	638	793	1144	1376	-	-	-	-	-	-
1/4"	618	710	821	932	1054	1279	1632	1890	2057	2333	-	-	-	-
5/16"	1095	1250	1434	1614	1802	2159	2534	2910	3412	3988	4846	-	-	-
3/8"	1709	1946	2201	2474	2747	3286	3822	4364	4897	5442	7159	8661	-	-
7/16"	-	-	4043	4482	4870	5670	6513	7358	8187	8985	10721	12280	-	-
1/2"	-	-	4649	5154	5601	6520	7490	8462	9415	10333	12329	14122	20407	24543
5/8"	-	-	8600	8808	9519	11092	12438	14637	15351	16739	20808	23953	29410	33194
3/4"	-	-	-	-	17622	19436	21800	24195	26565	29047	37964	43387	-	-
7/8"	-	-	-	-	-	32544	37329	41473	46076	50583	59400	68496	76841	85798
1"	-	-	-	-	-	47094	52952	58725	64425	71558	82959	95177	107394	119612

STAINLESS STEEL 304-A2 HEX NUT (DIN 934 / IS 1363)

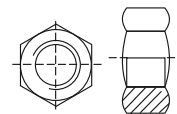

TABLE - 1C

SIZE	M 2	M 2.5	M 3	M 4	M 5	M 6	M 8	M 10	M 12	M 14	M 16	M 18	M 20	M 22	M 24	M 27	M 30	M 33	M 36
304	150	183	90	113	135	234	474	1049	1588	2571	3279	6294	6294	10640	10640	23463	37472	44652	59008

STAINLESS STEEL 304-A2 HEX NUT (BS 1083)

TABLE - 1D

BSW	1/8"	5/32"	3/16"	1/4"	5/16"	3/8"	7/16"	1/2"	5/8"	3/4"	7/8"	1"
304	153	162	183	372	529	883	1925	2268	4270	8276	12331	18994

STAINLESS STEEL 304-A2 LONG LENGTH HEX SCREW (DIN 933 / IS 1363)

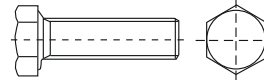
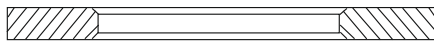

TABLE - 2A

DIA	110	120	125	130	140	150	160	170	175	180	190	200
6	3550	4000	4650	5100	5650	6000	-	-	-	-	-	-
8	4086	4387	4542	4765	5167	5482	10994	12976	-	13850	-	15145
10	6560	7191	7490	7694	8175	9027	10932	13676	13983	14446	15826	16540
12	9247	10024	10523	11065	11670	12566	13391	17698	20420	21456	24609	25578
14	17203	18516	19171	19827	21140	22452	23765	25078	26390	27703	29015	30327
16	17648	19037	19668	20260	21505	23122	24779	27952	31057	30538	33839	33268
18	30124	32237	33294	34349	36463	38574	40688	46598	47719	49964	53331	56698
20	30615	32185	33170	34338	36388	38545	40298	43629	49275	48182	56794	59301
22	47936	51214	52852	54489	57766	61043	66330	69708	71398	73087	76466	79847
24	49384	52677	54349	56131	59375	62634	66831	69971	75304	73421	80673	80198

STAINLESS STEEL 304-A2 PLAIN WASHER (DIN 125 / IS 2016)

TABLE - 2B



THICK	1.2MM	1.6MM	2MM	2.5MM	3MM	IS
M3 (1/8")	90	-	-	-	-	90
M4 (5/32")	100	-	-	-	-	100
M5 (3/16")	120	170	-	-	-	120
M6 (1/4")	172	250	340	-	-	250
M8 (5/16")	225	300	365	-	700	300
M10 (3/8")	350	465	600	-	1100	600
M12 (1/2")	460	640	835	1240	1450	1200
M14 (9/16")	547	850	1050	1500	1750	1750
M16 (5/8")	700	980	1225	-	2000	2000
M18	1000	1175	1600	-	2500	2500
M20 (3/4")	1100	1425	1700	-	2800	2800
M22 (7/8")	1400	1600	2000	-	3250	3250
M24 (1")	1560	1900	2500	-	4300	6000
M27 (1.1/8")	-	-	-	-	4800	6650
M30 (1.1/4")	-	-	-	-	6350	8700
M33 (1.3/8")	-	-	-	-	8500	12000
M36 (1.1/2")	-	-	-	-	8850	14600

STAINLESS STEEL 304-A2 SPRING WASHER (DIN 127 / IS 3063)

TABLE - 2C

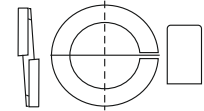

BSW	SQUARE	FLAT
M3 (1/8")	80	120
M4 (5/32")	90	130
M5 (3/16")	100	156
M6 (1/4")	125	250
M8 (5/16")	180	325
M10 (3/8")	300	500
M12 (1/2")	500	750
M14 (9/16")	800	1400
M16 (5/8")	1050	1650
M18	1400	2250
M20 (3/4")	1900	2875
M22 (7/8")	2500	4000
M24 (1")	3920	5250
M27 (1.1/8")	4200	6000
M30 (1.1/4")	5800	7500
M33 (1.3/8")	9800	12800
M36 (1.1/2")	11900	14600

STAINLESS STEEL 304-A2 THREADED ROD 1 MTR LENGTH (DIN 975)

TABLE - 2D

SIZE	M 3	M 4	M 5	M 6	M 8	M 10	M 12	M 14	M 16	M 18	M 20	M 22	M 24
304	15942	15942	16446	16928	28747	44988	65678	100848	119970	170492	187453	263488	312052

STAINLESS STEEL 304-A2 THREADED ROD 1 MTR LENGTH (BS 1083 / ANSI B18.2.1)

TABLE - 2E

DIA	3/16"	1/4"	5/16"	3/8"	1/2"	5/8"	3/4"	7/8"	1"
RATE	15876	19775	31289	44790	82952	127442	185688	256087	346571

**STAINLESS STEEL 304-A2 CHEESE HEAD (DIN 84) /
ROUND HEAD SLOTTED SCREW (DIN 85)**

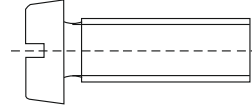

TABLE - 3A

DIA	4	6	8	10	12	16	20	25	30	35	40	50	60	70	80	90	100
2	169	162	162	169	176	209	246	-	-	-	-	-	-	-	-	-	-
2.5	176	169	179	196	209	238	283	394	-	-	-	-	-	-	-	-	-
3	-	196	192	205	224	259	304	380	554	714	696	994	-	-	-	-	-
4	-	255	263	276	300	352	403	477	557	623	730	903	-	-	-	-	-
5	-	390	406	431	482	537	606	702	800	905	1035	1257	-	-	-	-	-
6	-	-	-	666	703	826	911	1089	1218	1399	1554	1857	2215	2518	2851	2992	3363
8	-	-	-	-	-	1956	2213	2353	2661	2911	3279	3892	4056	4519	4959	5572	6232
10	-	-	-	-	-	-	3439	3853	4340	4825	5264	6159	7219	8320	9201	10214	10865

**STAINLESS STEEL 304-A2 CHEESE HEAD /
ROUND HEAD SLOTTED SCREW (BS 450)**

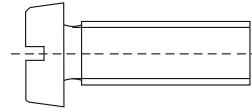

TABLE - 3B

BSW	1/4"	3/8"	1/2"	3/4"	1"	1.1/4"	1.1/2"	2"	2.1/2"	3"
1/8"	194	213	236	289	369	583	738	1108	-	-
5/32"	239	271	304	379	445	521	702	889	-	-
3/16"	305	372	430	530	647	763	884	1108	-	-
1/4"	-	722	782	957	1135	1350	1520	1939	2420	2829
5/16"	-	-	1735	2002	2284	2599	2940	3796	4567	5414
3/8"	-	-	2796	3075	3450	4265	4690	5765	6874	8483

**STAINLESS STEEL 304-A2 COUNTERSUNK (CSK)
SLOTTED HEAD SCREW (DIN 963)**

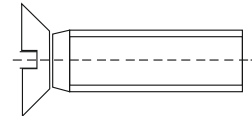

TABLE - 3C

DIA	4	6	8	10	12	16	20	25	30	35	40	50	60	70	80	90	100
2	171	162	161	170	174	207	248	-	-	-	-	-	-	-	-	-	-
2.5	174	170	180	196	207	248	284	329	-	-	-	-	-	-	-	-	-
3	-	168	164	176	211	231	311	355	526	684	-	-	-	-	-	-	-
4	-	208	210	243	253	302	352	411	504	557	685	935	-	-	-	-	-
5	-	284	313	339	376	431	514	597	709	821	943	1141	-	-	-	-	-
6	-	-	-	509	547	606	738	904	991	1150	1286	1608	1974	2284	2519	-	-
8	-	-	-	-	-	1613	1828	2066	2348	2620	2950	3625	4211	4794	5530	-	-
10	-	-	-	-	-	-	2849	3227	3724	4197	4704	5701	6533	7958	8917	10153	10953
12	-	-	-	-	-	-	4874	5192	5819	6241	7200	8634	9795	10310	12186	13596	14844

**STAINLESS STEEL 304-A2 COUNTERSUNK (CSK)
SLOTTED HEAD SCREW (BS 240)**

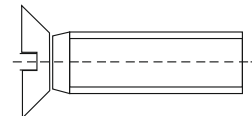

TABLE - 3D

BSW	1/4"	3/8"	1/2"	3/4"	1"	1.1/4"	1.1/2"	2"	2.1/2"	3"	3.1/2"	4"
1/8"	174	194	226	267	355	571	725	1096	-	-	-	-
5/32"	203	238	275	349	434	501	667	864	-	-	-	-
3/16"	251	294	335	437	587	738	854	1065	-	-	-	-
1/4"	-	540	666	798	958	1170	1325	1753	2302	2709	-	-
5/16"	-	-	1579	1883	2146	2599	2940	3751	4567	5414	-	-
3/8"	-	-	2796	2755	3132	3855	4215	5295	6317	8114	-	-
1/2"	-	-	-	-	5986	7318	8345	10268	12209	13861	16045	21612

STAINLESS STEEL 304-A2 PAN PHILIPS M/C AS PER (DIN 7985)

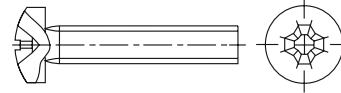

TABLE - 4A

DIA	4	6	8	10	12	16	20	25	30	35	40	50	60	70	80	90	100
2	141	135	135	141	147	174	205	-	-	-	-	-	-	-	-	-	-
2.5	147	141	149	163	174	199	236	328	-	-	-	-	-	-	-	-	-
3	-	151	148	158	172	199	234	293	426	549	535	764	-	-	-	-	-
4	-	212	219	230	250	293	336	398	464	519	608	752	-	-	-	-	-
5	-	325	338	360	402	447	505	585	667	755	863	1047	-	-	-	-	-
6	-	-	-	555	586	689	759	908	1015	1166	1295	1548	1846	2099	2376	2494	2802
8	-	-	-	-	-	1630	1844	1961	2217	2426	2733	3244	3380	3766	4132	4643	5193
10	-	-	-	-	-	-	2866	3211	3617	4021	4386	5133	6016	6934	7668	8512	9054

STAINLESS STEEL 304-A2 PAN PHILIPS M/C

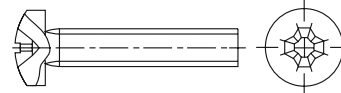

TABLE - 4B

BSW	1/4"	3/8"	1/2"	3/4"	1"	1.1/4"	1.1/2"	2"	2.1/2"	3"		
1/8"	149	164	182	222	284	448	568	852	-	-		
5/32"	199	226	253	316	371	435	585	741	-	-		
3/16"	254	310	358	442	539	636	737	923	-	-		
1/4"	-	602	651	798	946	1125	1267	1616	2017	2357		
5/16"	-	-	1446	1669	1903	2166	2450	3164	3806	4511		
3/8"	-	-	2330	2562	2875	3554	3908	4804	5728	7069		

STAINLESS STEEL 304-A2 CSK PHILIPS M/C AS PER (DIN 965)

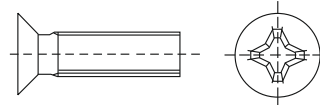

TABLE - 4C

	4	6	8	10	12	16	20	25	30	35	40	50	60	70	80	90	100
2	143	135	135	141	145	172	206	-	-	-	-	-	-	-	-	-	-
2.5	145	141	150	163	172	206	236	274	-	-	-	-	-	-	-	-	-
3	-	129	126	136	162	177	239	273	405	526	-	-	-	-	-	-	-
4	-	173	175	203	211	251	294	343	420	464	571	779	-	-	-	-	-
5	-	237	261	283	314	360	428	497	591	684	785	951	-	-	-	-	-
6	-	-	-	424	455	505	615	753	826	959	1072	1340	1645	1903	2099	-	-
8	-	-	-	-	-	1344	1523	1722	1956	2184	2458	3021	3509	3995	4609	-	-
10	-	-	-	-	-	-	2374	2689	3103	3497	3920	4751	5444	6631	7431	8461	9127
12	-	-	-	-	-	-	4061	4327	4849	5200	6000	7195	8163	8592	10155	11330	12370

STAINLESS STEEL 304-A2 CSK PHILIPS

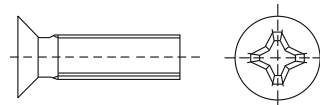

TABLE - 4D

BSW	1/4"	3/8"	1/2"	3/4"	1"	1.1/4"	1.1/2"	2"	2.1/2"	3"	3.1/2"	4"
1/8"	134	150	174	206	273	439	558	843	-	-	-	-
5/32"	169	199	229	290	361	418	556	720	-	-	-	-
3/16"	209	245	279	364	489	615	712	888	-	-	-	-
1/4"	-	450	555	665	798	975	1104	1460	1919	2258	-	-
5/16"	-	-	1316	1569	1788	2166	2450	3126	3806	4511	-	-
3/8"	-	-	2330	2296	2610	3212	3512	4412	5264	6761	-	-
1/2"	-	-	-	-	4989	6098	6954	8557	10174	11550	13371	18010

STAINLESS STEEL 304-A2 ALLEN CAP SCREW (DIN 912)

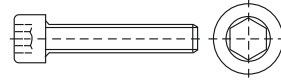

TABLE - 5A

DIA	6	8	10	12	16	20	25	30	35	40	45	50	60	70	75	80	90	100
3	362	352	360	369	412	455	526	688	-	-	-	-	-	-	-	-	-	-
4	440	418	387	398	458	513	552	671	754	909	1071	1233	1650	2195	2545	2896	3794	4932
5	-	484	512	542	607	674	762	878	1002	1171	1296	1421	1713	2072	2279	2486	2983	3579
6	-	-	714	734	788	854	969	1073	1158	1345	1498	1548	1908	2231	2485	2820	3206	3771
8	-	-	-	1715	1557	1627	1801	2064	2251	2415	2630	2787	3322	3674	4297	4532	5272	5656
10	-	-	-	-	3113	2878	3231	3411	3787	4053	4337	4661	5259	5971	6316	6661	8193	9003
12	-	-	-	-	-	5586	5313	5417	5754	6199	6730	7103	8003	8542	9345	10058	10906	11980
14	-	-	-	-	-	-	9544	9750	10266	10786	11535	12223	13607	15329	17200	17691	19723	21713
16	-	-	-	-	-	-	-	12476	11598	12695	13751	14228	15909	17678	18769	19597	21520	23508
18	-	-	-	-	-	-	-	-	-	23485	24607	26029	28972	31215	33452	34892	37663	41100
20	-	-	-	-	-	-	-	-	-	24213	25168	26597	29591	32418	34127	35568	38440	41782
22	-	-	-	-	-	-	-	-	-	-	-	49192	54614	58084	62845	65256	70274	76498
24	-	-	-	-	-	-	-	-	-	-	-	60118	65151	70185	71636	75218	80253	85286

STAINLESS STEEL 304-A2 ALLEN CAP SCREW (BS 2470)

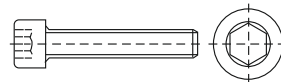

TABLE - 5B

BSW	1/2"	3/4"	1"	1.1/4"	1.1/2"	2"	2.1/2"	3"	3.1/2"	4"
3/16"	763	781	843	939	1090	-	-	-	-	-
1/4"	1012	1094	1213	1367	1571	1907	2414	3070	3751	4225
5/16"	1728	1817	1892	2210	2422	2858	3694	4378	-	-
3/8"	-	2673	2812	3162	3581	4362	5271	6323	7200	7832
1/2"	-	-	-	7053	7746	8702	10104	11328	13709	15914
5/8"	-	-	-	-	13822	15895	18885	22301	26032	27799
3/4"	-	-	-	-	29492	32480	39588	41672	46941	50967

STAINLESS STEEL 304-A2 ALLEN CAP SCREW LONG LENGTH (DIN 912)

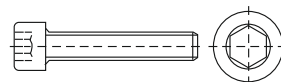

TABLE - 5C

DIA	110	120	125	130	140	150
8	6930	7991	8983	9768	12086	13928
10	11413	12364	13121	13782	16603	17773
12	13711	15504	16496	16728	17867	18522
14	26622	28515	29462	31169	33109	35050
16	31126	33688	35359	38390	41114	41528
18	44537	47974	49665	51410	54847	58285
20	49867	52549	53890	55890	57892	62378
22	80850	85298	86743	88857	92384	97817
24	93665	98886	97775	100357	105418	110456

STAINLESS STEEL 304-A2 LOCK NUT (DIN 439)



TABLE - 5D

SIZE	M 5	M 6	M 8	M 10	M 12	M 14	M 16	M 18	M 20	M 22	M 24	M 27	M 30	M 33	M 36
304	143	194	370	755	1106	2072	2225	4935	4935	8814	8814	20312	29124	38269	50090

STAINLESS STEEL 304-A2 ALLEN CSK CAP SCREW (DIN 7991)

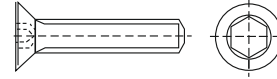

TABLE - 6A

DIA	8	10	12	16	20	25	30	35	40	50	60	70	80	90	100
3	129	140	160	191	260	347	-	-	-	-	-	-	-	-	-
4	199	212	223	267	294	364	423	476	559	-	-	-	-	-	-
5	272	287	312	353	419	498	596	679	763	971	-	-	-	-	-
6	-	436	477	543	638	754	886	1004	1215	1359	1603	2044	2632	3029	3648
8	-	-	-	1293	1352	1520	1708	1884	2068	2594	3181	3542	3866	4271	4835
10	-	-	-	-	2405	2731	3018	3206	3631	4294	4835	5549	6069	6814	7637
12	-	-	-	-	-	5558	5967	6585	6806	7881	8854	9929	10722	11917	13206
16	-	-	-	-	-	-	-	-	11831	14163	16493	18645	20975	23665	26353
20	-	-	-	-	-	-	-	-	19749	27687	30011	35624	38723	43757	48984

STAINLESS STEEL 304-A2 ALLEN CSK SCREW BSW THREAD AS PER (BS 2470)

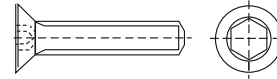

TABLE - 6B

DIA	1/2"	3/4"	1"	1.1/4"	1.1/2"	2"	2.1/2"	3"		
3/16"	746	886	979	1073	1259	1399	-	-		
1/4"	933	933	1073	1166	1353	1539	1912	-		
5/16"	-	2145	2332	2472	2845	3218	3778	4524		
3/8"	-	3545	3545	3731	4291	4851	5597	6716		
1/2"	-	-	7649	8395	11194	14925	17723	18656		

STAINLESS STEEL 304-A2 ALLEN GRUB SCREW (DIN 916)

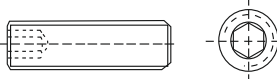

TABLE - 6C

DIA	3	4	5	6	8	10	12	16	20	25	30	35	40	45	50	55	60	65
3	151	136	140	151	174	207	283	566	754	-	-	-	-	-	-	-	-	-
4	204	160	169	184	223	251	302	408	532	727	971	-	-	-	-	-	-	-
5	271	195	204	232	292	351	408	562	727	1047	1308	1647	2086	-	-	-	-	-
6	-	307	270	281	355	439	532	728	933	1242	1559	1867	2334	2988	3734	-	-	-
8	-	-	-	514	607	748	933	1307	1681	2242	2801	3221	3688	4343	5136	5977	6458	-
10	-	-	-	897	897	1079	1330	1887	2469	3233	3994	4848	5835	6733	7633	8529	9876	-
12	-	-	-	-	1615	1660	2704	2783	3636	4714	5791	7002	8080	9426	10774	12121	13915	17955
16	-	-	-	-	-	-	6464	7182	8350	9426	11222	13018	14815	16162	17955	19752	21996	-

STAINLESS STEEL 304-A2 BUTTON HEAD CAP SCREW (ISO 7380)

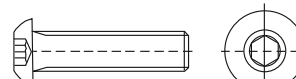
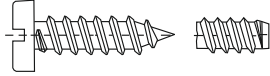

TABLE - 6D

DIA	8	10	12	16	20	25	30	35	40	50	60
3	154	157	177	222	266	301	-	-	-	-	-
4	202	199	226	264	311	370	448	530	641	-	-
5	291	339	350	421	480	550	628	754	808	-	-
6	-	430	457	541	639	764	886	1026	1156	1553	-
8	-	-	-	1187	1291	1528	1782	1973	2278	2611	3009
10	-	-	-	-	2603	2887	3384	3742	3913	4459	5326
12	-	-	-	-	6002	6604	7170	7963	9292	10719	12309

STAINLESS STEEL 304-A2 PAN PHILIPS (DIN 7981) TABLE - 7A
PAN SLOTTED (DIN 7971) SELF TAPPING SCREW



DIA	4	6	8	10	12	14
6.5	127	164	-	-	-	-
9.5	139	174	240	-	-	-
13	147	190	270	360	553	-
16	166	220	297	387	614	818
19	213	262	323	435	685	896
25	-	318	393	529	805	1091
32	-	372	482	628	978	1303
38	-	-	571	733	1127	1450
50	-	-	793	990	1307	1890

STAINLESS STEEL 304-A2 CSK PHILIPS (DIN 7982) TABLE - 7B
CSK SLOTTED (DIN 7972) SELF TAPPING SCREW

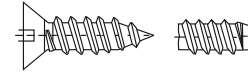

DIA	4	6	8	10	12	14
6.5	108	131	-	-	-	-
9.5	123	152	199	-	-	-
13	139	169	227	285	425	-
16	157	196	252	314	489	609
19	-	231	288	373	553	708
25	-	293	361	467	689	885
32	-	347	444	549	856	1128
38	-	-	522	668	990	1294
50	-	-	766	963	1142	1875

STAINLESS STEEL 304-A2 DOM NUT (DIN 1587)

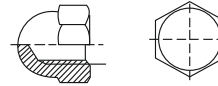

TABLE - 7C

SIZE	M 3	M 4	M 5	M 6	M 8	M 10	M 12	M 16	M 20	M 24
304	443	443	536	868	1657	3519	5560	13919	26419	56865

STAINLESS STEEL 304-A2 NYLOCK NUT (DIN 982 / DIN 985)

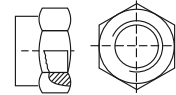

TABLE - 7D

SIZE	M 3	M 4	M 5	M 6	M 8	M 10	M 12	M 16	M 20	M 24	M 30
304	265	253	325	504	905	1693	2631	5734	17662	54363	98604

STAINLESS STEEL 304-A2 SQUARE NUT (DIN 557) TABLE - 7E

DIA	M5	M6	M8	M10	M12
304Q	370	370	852	1874	2853

STAINLESS STEEL 304-A2 HEX NUT (H=D)

TABLE - 7F

SIZE	M6x6	M8x8	M10x10	M12x12	M16x16	M18x18	M20x20	M22x22	M24x24
304Q	361	722	1590	2319	4750	8100	10230	14631	16440

STAINLESS STEEL 304-A2 FLANGE NUT (DIN 6923) TABLE - 7G

DIA	M5	M6	M8	M10	M12
304Q	388	454	1008	1734	2934

STAINLESS STEEL 304-A2 WELD NUT (DIN 929)

TABLE - 7H

DIA	M5	M6	M8	M10	M12
304Q	388	454	1008	1734	2934

STAINLESS STEEL 304-A2 HEAVY HEX NUT (ANSI B18.2.2)

TABLE - 7I

DIA	5/16" UNC	3/8" UNC	1/2" UNC	5/8" UNC	3/4" UNC	7/8" UNC		
304Q	1604	2248	3435	6920	11727	17171		

STAINLESS STEEL 304-A2 WING NUT (DIN 315) LIGHT

TABLE - 7J

SIZE	M 3	M 4	M 5	M 6	M 8	M 10	M 12	
304	1436	1438	1561	1987	3083	3885	8580	

STAINLESS STEEL 304-A2 WING NUT (HEAVY)

TABLE - 7K

DIA	M5	M6	M8	M10	M12	M16	M20	M24
HEAVY	6394	6821	11082	13981	23444	35805	72463	105881

DIA	3/16"	1/4"	5/16"	3/8"	1/2"	5/8"	3/4"	1"
HEAVY	6394	6821	11082	13981	23444	35805	72463	105881

STAINLESS STEEL 316-A4 HEX SCREW (DIN 933 / IS 1363)

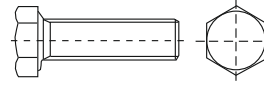

TABLE - 8A

DIA	10	12	16	20	25	30	35	40	45	50	55	60	65	70	75	80	85	90	100
5	704	717	809	916	1021	1140	1260	1375	1527	1658	1823	1920	2122	2234	2412	-	-	-	-
6	749	763	861	974	1086	1213	1340	1463	1624	1764	1939	2043	2257	2377	2566	2674	3009	3081	3378
8	-	-	1763	1968	2192	2426	2657	2884	3155	3350	3624	3819	4125	4280	4505	4804	5202	5389	5801
10	-	-	3349	3664	4009	4346	4676	5049	5409	5789	6160	6541	7040	7246	7785	8012	8620	8785	9393
12	-	-	-	5459	5920	6436	6989	7523	7848	8593	8909	9654	9936	10713	11290	11829	12190	12966	14057
14	-	-	-	-	9133	9728	10450	11026	11811	12496	13393	13879	14868	15449	16232	17001	18495	19445	19999
16	-	-	-	-	11896	12494	13460	14433	15347	16375	17357	18450	19175	20191	20973	22391	23429	24390	26144
18	-	-	-	-	-	-	-	23355	24964	26572	28181	29791	31397	33006	34614	36224	37833	39439	42657
20	-	-	-	-	-	-	-	24877	26743	28098	29193	30752	32416	34270	35742	37440	38899	40476	43409
22	-	-	-	-	-	-	-	38518	41043	43567	46091	48050	50045	52040	54533	57029	58524	60019	65009
24	-	-	-	-	-	-	-	-	-	44023	46461	48867	51186	53736	55925	58300	60642	61096	65775

STAINLESS STEEL 316-A4 HEX SCREW (BS - 1083)

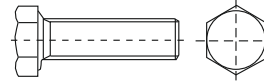

TABLE - 8B

BSW	1/2"	3/4"	1"	1.1/4"	1.1/2"	2"	2.1/2"	3"	3.1/2"	4"	5"	6"	7"	8"
1/4"	956	1113	1288	1493	1648	2001	2483	2869	3164	3590	-	-	-	-
5/16"	1696	1955	2243	2528	2820	3386	3970	4554	5267	6347	-	-	-	-
3/8"	2640	3026	3430	3852	4275	5113	5947	6787	7619	8462	10762	12872	-	-
1/2"	-	-	7270	8045	8758	10216	11722	13233	14724	16179	19117	21762	-	-
5/8"	-	-	13270	13778	14887	17406	19592	22894	24008	26156	32257	37051	-	-
3/4"	-	-	-	-	29261	32273	36199	40175	44112	48233	56271	64310	-	-
7/8"	-	-	-	-	-	47088	54012	60010	66669	73190	85948	99108	111182	124143
1"	-	-	-	-	-	66166	74398	82507	90515	100538	116556	133722	150886	168053

STAINLESS STEEL 316-A4 LONG LENGTH HEX SCREW (DIN 933 / IS 1363)

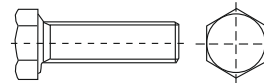

TABLE - 8C

DIA	110	120	125	130	140	150	160	170	175	180	190	200
6	5700	6350	7425	8200	9150	9725	-	-	-	-	-	-
8	6348	6804	7020	7330	7897	8390	-	-	-	-	-	21050
10	10343	11193	11595	11948	12592	13314	14606	18118	18383	19713	20645	21576
12	14718	15906	16616	17349	18341	19634	20805	27669	31200	33288	35376	35327
14	25030	26939	27895	28850	30760	32670	34580	36488	38399	40309	42219	44129
16	28504	30563	31559	32538	34347	36904	39277	43268	45008	46749	48740	50732
18	45438	48623	50217	51810	54997	58183	61369	66148	67738	68201	72190	74630
20	47627	50614	52163	54000	57224	60617	63372	66678	68293	69709	73194	76678
22	71303	76246	78715	81186	86129	91070	95013	99719	102025	104425	108840	112782
24	72732	77581	80044	82668	87447	92246	96976	101533	104035	106538	111456	116372

STAINLESS STEEL 316-A4 HEX NUT (DIN 934 / IS 1363)

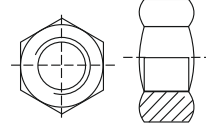

TABLE - 9A

SIZE	M 2	M 2.5	M 3	M 4	M 5	M 6	M 8	M 10	M 12	M 14	M 16	M 18	M 20	M 22	M 24	M 27	M 30	M 33	M 36
316	333	329	152	203	258	404	818	1713	2670	4513	5340	10157	10157	16989	16989	33860	44349	56004	76619

STAINLESS STEEL 316-A4 HEX NUT (BS 1083)

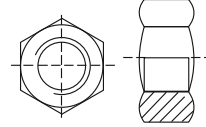

TABLE - 9B

DIA	1/8"	5/32"	3/16"	1/4"	5/16"	3/8"	7/16"	1/2"	5/8"	3/4"	7/8"	1"
316Q	278	304	313	619	896	1475	3379	3907	7013	12806	16851	25956

STAINLESS STEEL 316-A4 LOCK NUT (DIN 439)



TABLE - 9C

DIA	M5	M6	M8	M10	M12	M14	M16	M18	M20	M22	M24
316Q	278	352	715	1208	2360	3830	4724	9302	9302	15696	15696

STAINLESS STEEL 316-A4 DOM NUT

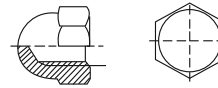

TABLE - 9D

DIA	M5	M6	M8	M10	M12	M16	M20	M24
316Q	879	1409	3036	5304	8168	20200	37176	79166

STAINLESS STEEL 316-A4 HEX NYLOCK NUT (DIN 982 / DIN 985)

TABLE - 9E

DIA	M3	M4	M5	M6	M8	M10	M12	M16	M20	M24
316Q	384	367	471	731	1312	2455	3815	8315	22144	75173

STAINLESS STEEL 316-A4 HEAVY HEX NUT (ANSI B18.2.2)

TABLE - 9F

DIA	5/16" UNC	3/8" UNC	1/2" UNC	5/8" UNC	3/4" UNC	7/8" UNC
316Q	2363	3137	5419	10701	18271	25984

STAINLESS STEEL 316-A4 HEIGHT DIA NUT (DIN 5587)

TABLE - 9G

SIZE	M6 X 6	M8 X 8	M10 X 10	M12 X 12	M16 X 16	M18 X 18	M20 X 20	M22 X 22	M24 X 24
316Q	555	1141	2507	3671	7566	14964	15752	23904	25163

STAINLESS STEEL 316-A4 THREADED ROD 1 MTR LENGTH (DIN 975)

TABLE - 9H

SIZE	M 6	M 8	M 10	M 12	M 14	M 16	M 18	M 20	M 22	M 24
316	25612	44212	69192	101010	168305	184511	284533	288299	407160	482204

STAINLESS STEEL 316-A4 THREADED ROD 1 MTR LENGTH (BS 1083 / ANSI B18.2.1)

TABLE - 9I

DIA	1/4"	5/16"	3/8"	1/2"	5/8"	3/4"	7/8"	1"
316Q	32307	49494	72138	133602	205253	299066	412447	558180

**STAINLESS STEEL 316-A4 PLAIN WASHER
(DIN 125 / IS 2016)**

TABLE - 10A

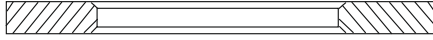

THICK	1.2MM	1.6MM	2MM	2.5MM	3MM	IS
M3 (1/8")	160	-	-	-	-	160
M4 (5/32")	180	-	-	-	-	180
M5 (3/16")	210	-	-	-	-	210
M6 (1/4")	225	300	-	-	-	300
M8 (5/16")	330	425	550	-	875	425
M10 (3/8")	500	700	800	-	1400	800
M12 (1/2")	700	900	1125	1400	1870	1400
M14 (9/16")	775	1200	1500	1900	2050	2050
M16 (5/8")	900	1400	1600	-	2450	2450
M18	-	1600	2000	-	3100	3100
M20 (3/4")	1350	1850	2300	-	3500	3500
M22 (7/8")	-	-	-	-	4000	4000
M24 (1")	-	-	-	-	5000	6600
M27 (1.1/8")	-	-	-	-	6750	8800
M30 (1.1/4")	-	-	-	-	7950	10700
M33 (1.3/8")	-	-	-	-	12200	15000
M36 (1.1/2")	-	-	-	-	12800	18800

STAINLESS STEEL 316-A4 SPRING WASHER (DIN 127 / IS 3063)

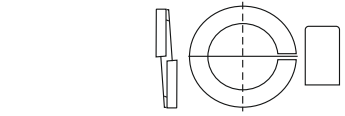

BSW	SQUARE	FLAT
M3 (1/8")	150	200
M4 (5/32")	160	220
M5 (3/16")	200	250
M6 (1/4")	230	275
M8 (5/16")	300	475
M10 (3/8")	500	700
M12 (1/2")	600	1100
M14 (9/16")	950	1400
M16 (5/8")	1400	2325
M18	1600	2800
M20 (3/4")	2500	4067
M22 (7/8")	3300	4600
M24 (1")	5050	6700
M27 (1.1/8")	5500	8200
M30 (1.1/4")	7700	11000
M33 (1.3/8")	14000	16500
M36 (1.1/2")	16200	17800

STAINLESS STEEL 316-A4 ALLEN CAP SCREW (DIN 912)

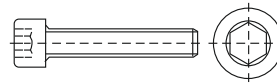

TABLE - 10C

DIA	6	8	10	12	16	20	25	30	35	40	45	50	60	70	75	80	90	100
3	417	432	441	451	516	572	672	-	-	-	-	-	-	-	-	-	-	-
4	565	567	504	544	612	685	761	949	1078	1251	-	-	-	-	-	-	-	-
5	-	-	706	745	845	941	1079	1232	1430	1649	1823	1998	-	-	-	-	-	-
6	-	-	1028	1057	1176	1277	1403	1577	1718	1988	2193	2330	2833	3160	3470	3813	4412	5239
8	-	-	-	2433	2361	2486	2737	3145	3376	3635	3998	4189	4818	5563	6228	6649	7548	8100
10	-	-	-	-	-	4312	4888	5157	5610	6160	6565	7068	7974	9094	9568	10128	12521	13796
12	-	-	-	-	-	-	7778	8081	8667	9382	10239	10735	12127	12935	14062	15130	16391	17841
16	-	-	-	-	-	-	-	-	17911	19652	21280	22028	24736	27158	28819	31602	34797	37709
20	-	-	-	-	-	-	-	-	-	40595	42418	45166	49981	55120	57511	60051	65112	70198

TERMS & CONDITIONS :

1. This cancels our previous price list.
2. The all above prices are nett. Ex. Factory.
3. GST Tax as applicable extra.
4. Transport charges extra as applicable.
5. Prices may differ subject to quantity order.
6. TC charges extra as applicable.